

Ceiling Attenuation Class for Gridstone Ceiling Assemblies

Figure 72

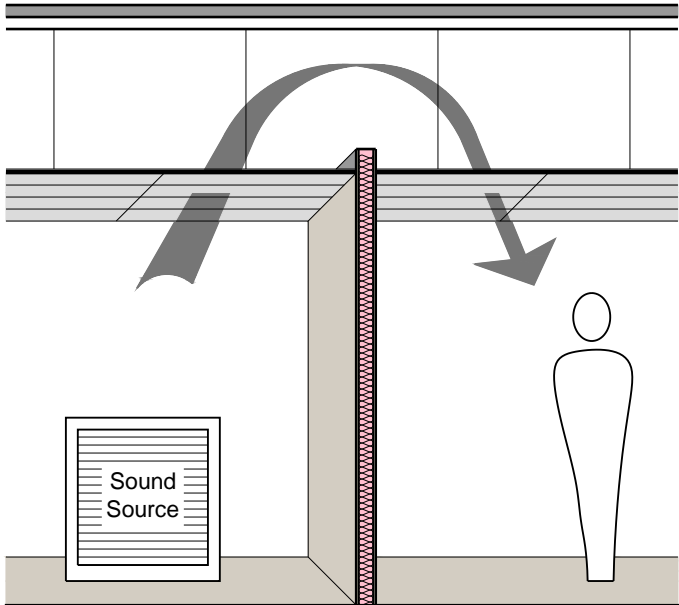

CAC-41 **NGC 6000001**

Ceiling: Suspended Grid with 2' x 4' x 5/16" Gridstone
Hi-Strength Ceiling Panels
Insulation: None

Figure 72

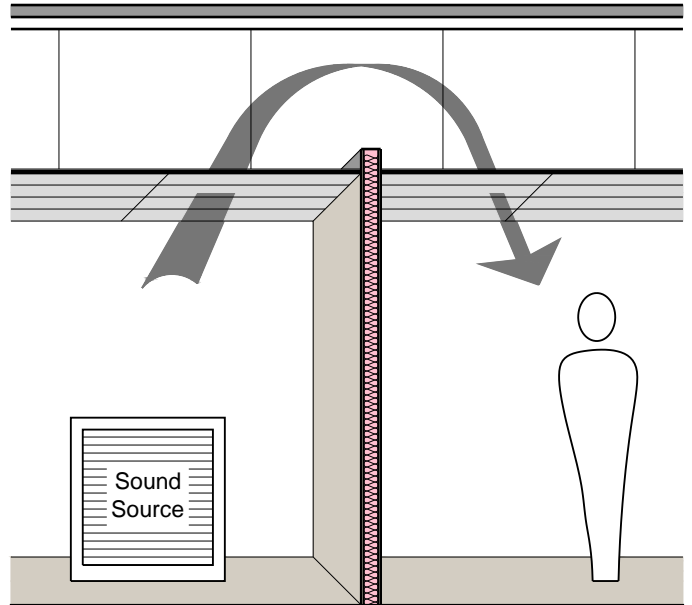

CAC-46 **NGC 6098001**

Ceiling: Suspended Grid with 2' x 4' x 1/2" Gridstone
Ceiling Panels
Insulation: None

Figure 72

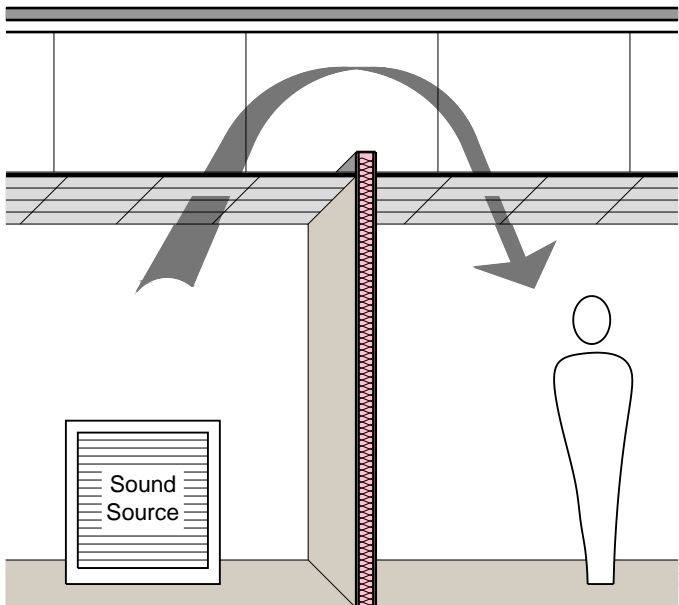

CAC-44 **NGC 6013012**

Ceiling: Suspended Grid with 2' x 2' x 1/2" Gridstone
Ceiling Panels
Insulation: None

Figure 72

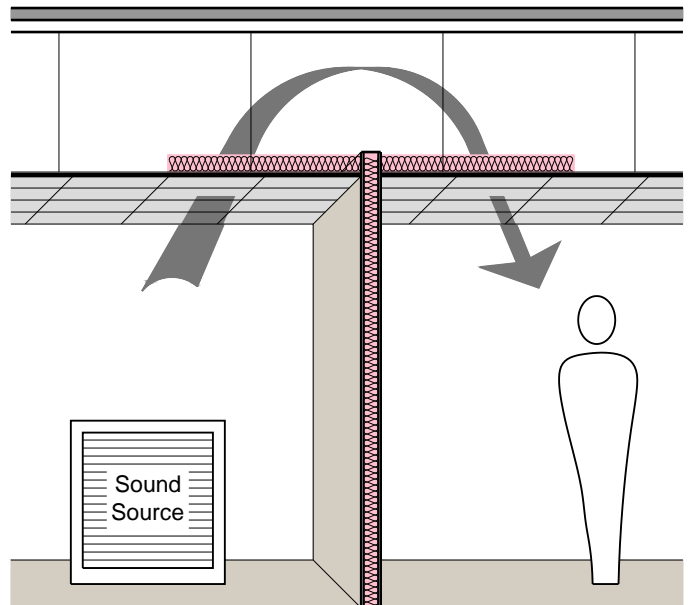

CAC-51 **NGC 6013013**

Ceiling: Suspended Grid with 2' x 2' x 1/2" Gridstone
Ceiling Panels
Insulation: 3 1/2" glass fiber 48" on each side of partition

Ceiling Attenuation Class for Gridstone Ceiling Assemblies

Figure 72

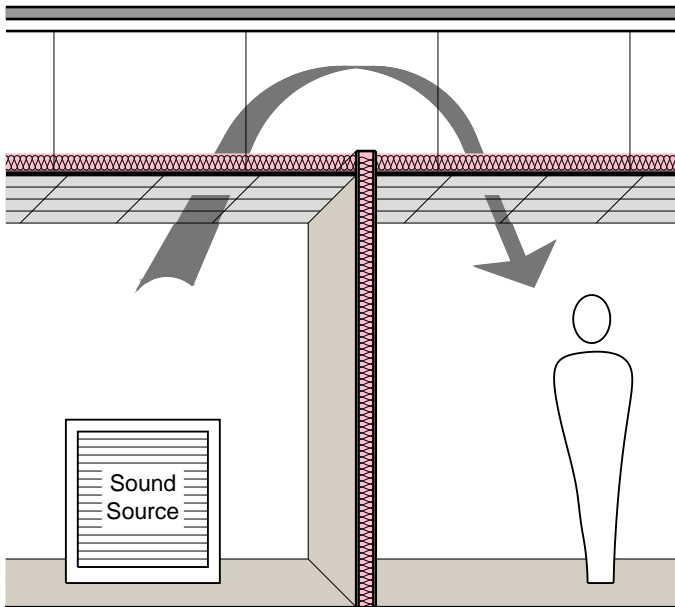

CAC-53

NGC 6013014

Ceiling: Suspended Grid with 2' x 2' x 1/2" Gridstone Ceiling Panels

Insulation: 3-1/2" glass fiber full coverage over ceiling